

BIKE	KAWASAKI ZX6	PART NO.	KA-1001
YEAR	2009 - 2012	FIT KITS	ROUND Z039.10392
NOTES	Use standard fittings where not supplied Remove standard gasket if fitted.	FEATURES	Db Killer:- Z038.10530 (EE)

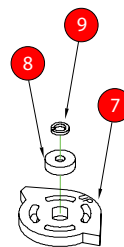
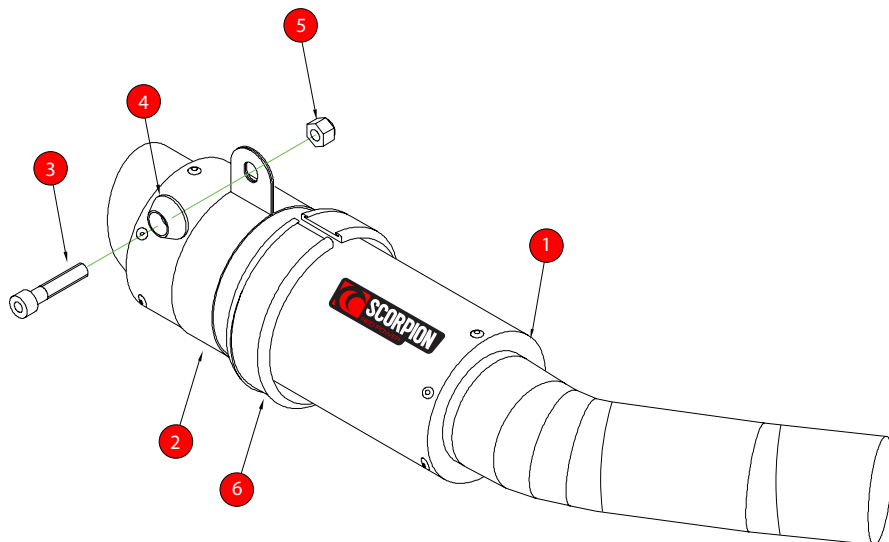

- | | |
|---|---------------------------------|
| 1 225mm RP-1 GP silencer SC160 with integrated CP 583 | 8 Aluminium collar (Z026.20045) |
| 2 Titanium Silencer Strap (Z028.10013) | 9 M6 split washer (Z017.10027) |
| 3 M8 x 40mm Cap Head Bolt (Z017.10076) | |
| 4 1 of Bolt Finisher (Z026.20068) | |
| 5 M8 Nyloc nut (Z017.10062) | |
| 6 Square edge rubber (Z029.10024) | |
| 7 Servo wheel (Z007.10955) | |

E-MARK	KA85 e4 2359 9
ISSUE NO.	3
DATE	26/09/17
AUTHORISED	S.PEPPER
CHECKED	

NOTE: ENSURE SCORPION SYSTEM IS CLEAR OF MOVING PARTS AND ALL ORIGINAL FUNCTIONS WORK CORRECTLY.



A) Remove original exhaust from bike, taking care to keep all original components in a safe place.

B) Refit Scorpion exhaust as per line diagram above.

C) when fitted take bike for a short ride to ensure all functions are correct.

D) when bike & exhaust are cool enough check all nuts and bolts are still secure.

BIKE	KAWASAKI ZX6	PART NO.	KA-1001
YEAR	2009 - 2012	FIT KITS	ROUND Z039.10392
NOTES	Use standard fittings where not supplied Remove standard gasket if fitted.	FEATURES	Db Killer:- Z038.10530 (EE)

CONTINUED FROM OVERLEAF:

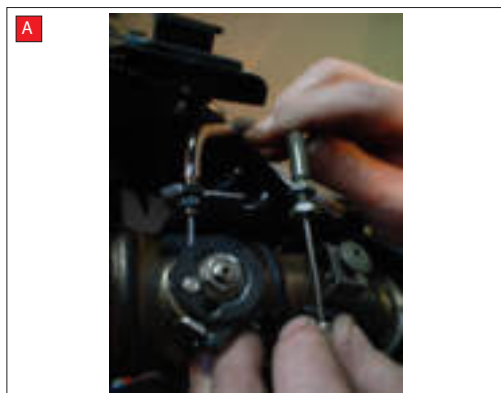

A) Disconnect cables on exhaust valve and leave loose..

B) To disconnect cables at the servo box end, you have to remove the hexagonal wheel, without turning it's shaft.
Remove bolt in centre of hexagonal wheel using an 8mm socket. Support wheel if tight.

C) Remove hexagonal wheel from shaft, retaining OE bolt. DO NOT turn shaft.

Remove spring clip retaining cables and completely remove the cables



D) The replacement wheel comes with an aluminium collar & spring washer that is secured in place with OE bolt – TIGHTEN TO 5ft/lb USING A TORQUE WRENCH.

The replacement wheel must be fitted with the etched letters "UP"



E IS RIGHT!

F IS WRONG!