

Box: PLOCK 1

BIKE	SUZUKI GSX 650F	PART NO.	ESI -101
YEAR	2007 - 2016	FIT KITS	OVAL Z039.11267 // ROUND Z039.10267
NOTES	Use standard fittings where not supplied Remove standard gasket if fitted.	FEATURES	DB KILLER Z038.10120

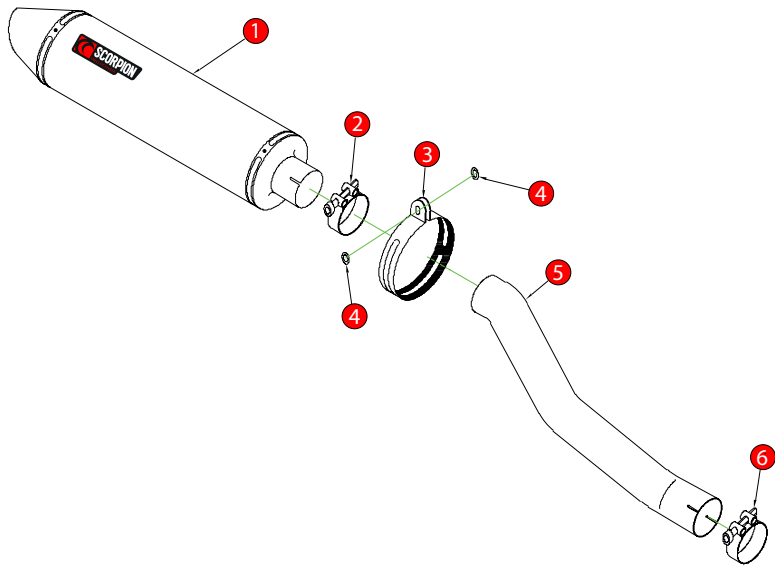

- 1 450mm Silencer ESC 110
- 2 51-55mm Band Clamp (Z016.10002)
- 3 Composite Silencer Strap (R-Z038.10090)(O-Z038.10088)
- 4 2 x M8 x 25mm Washers (Z017.10825)
- 5 Connecting Pipe CP431
- 6 55-59mm Band Clamp (Z016.10004)
- 7 Bump Stop Kit

E-MARK ROUND	SI-96 [e4] 2294 [9]
E-MARK OVAL	SI-96 [e4] 2294 [9]
ISSUE NO.	4
DATE	11/11/08
AUTHORISED	S.Northrop
CHECKED	

NOTE: ENSURE SCORPION SYSTEM IS CLEAR OF MOVING PARTS AND ALL ORIGINAL FUNCTIONS WORK CORRECTLY.

- A) Remove original exhaust from bike, taking care to keep all original components in a safe place.
- B) Refit Scorpion exhaust as per line diagram above.
- C) When fitted take bike for a short ride to ensure all functions are correct.
- D) When bike & exhaust are cool enough check all nuts and bolts are still secure.