

| | | | |
|-------|---|----------|-------------------------------------|
| BIKE | SUZUKI SV 650 | PART NO. | ESI - 65 |
| YEAR | 1999 - ON | FIT KITS | OVAL Z039.11082 // ROUND Z039.10082 |
| NOTES | Item 7 required to re-fit OE exhaust system | FEATURES | DB KILLER Z038.10120 |

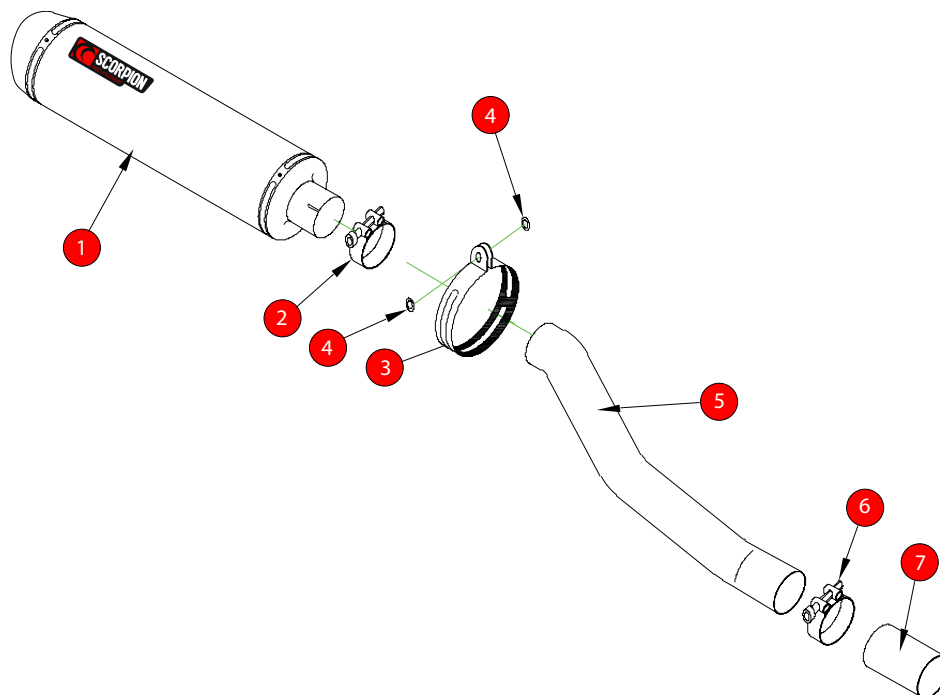

- | | |
|---|---------------------------------|
| 1 450mm Silencer ESC 94 | 8 Original Silencer Cut Diagram |
| 2 51-55mm Band Clamp (Z016.10002) | |
| 3 Composite Silencer Strap (R-Z038.10089)(O-Z038.10088) | |
| 4 2 x M8 x 25mm Washers (Z017.10825) | |
| 5 Connecting Pipe CP 325 | |
| 6 55-59mm Band Clamp (Z016.10004) | |
| 7 Re-connecting Sleeve CP327 | |

| | |
|------------|-----------------|
| E-MARK | SCDB-UC e4 2106 |
| ISSUE NO. | 13 |
| DATE | 07/08/09 |
| AUTHORISED | S.Northrop |
| CHECKED | |

NOTE: ENSURE SCORPION SYSTEM IS CLEAR OF MOVING PARTS AND ALL ORIGINAL FUNCTIONS WORK CORRECTLY.



A) Remove original exhaust from bike, taking care to keep all original components in a safe place.

B) Refit Scorpion exhaust as per line diagram above.

C) When fitted take bike for a short ride to ensure all functions are correct.

D) When bike & exhaust are cool enough check all nuts and bolts are still secure.

| | | | |
|-------|-------------------------------|----------|-------------------------------------|
| BIKE | SUZUKI SV 650 | PART NO. | ESI - 65 |
| YEAR | 1999 - ON | FIT KITS | OVAL Z039.11082 // ROUND Z039.10082 |
| NOTES | PIPEWORK CUTTING INSTRUCTIONS | FEATURES | DB KILLER Z038.10120 |

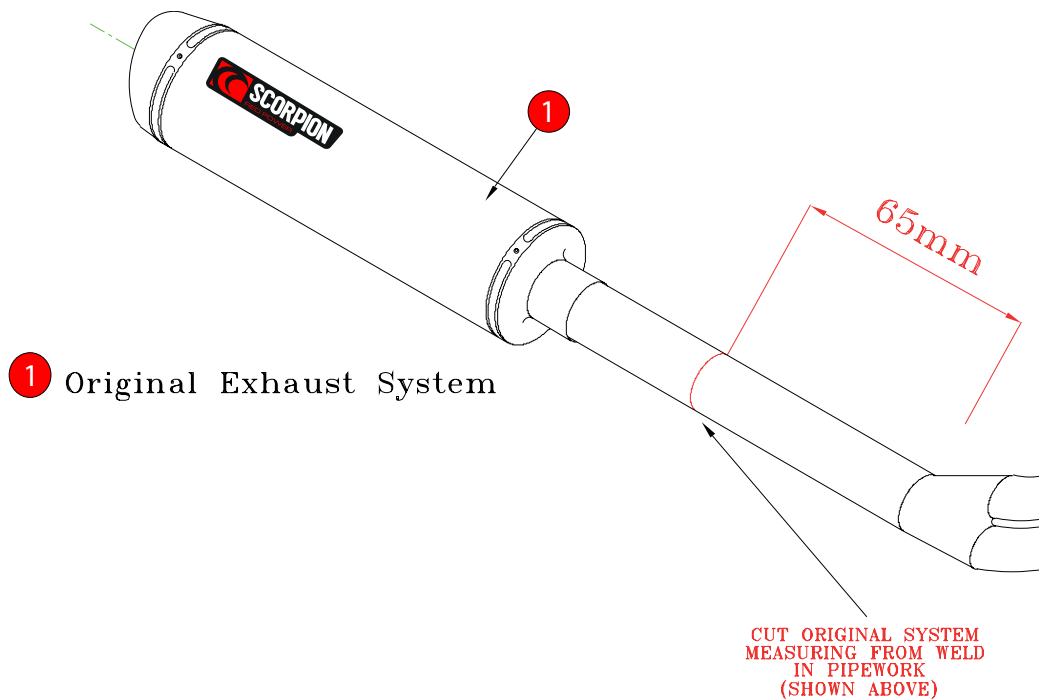

- | | |
|---|--|
| 1 Use correct tools and check parts list | 5 Use a small amount of silicone to seal joints |
| 2 Saw off standard silencer 65mm back from weld in pipework,(as illustrated) Clean sawn edge. | 6 Tighten all fasteners and check that it is clear of all moving parts, & all original functions are working correctly |
| 3 Connector pipe CP-327 should only be used to re-fit std silencer if required. | 7 Ride for a short distance and re-tighten all fasteners |
| 4 Use rubber strap under silencer bracket to prevent damage to silencer | |

| | |
|--------------|------------|
| E-MARK ROUND | |
| E-MARK OVAL | |
| ISSUE NO. | 10 |
| DATE | 11/06/08 |
| AUTHORISED | S.Northrop |
| CHECKED | |

NOTE: ENSURE SCORPION SYSTEM IS CLEAR OF MOVING PARTS AND ALL ORIGINAL FUNCTIONS WORK CORRECTLY.