

Box: PLOCK 2

BIKE	SUZUKI GSF 600 BANDIT	PART NO.	ESI - 54
YEAR	1995 - 2000	FIT KITS	OVAL Z039.11080 // ROUND Z039.10080
NOTES	Where not supplied use original fixings	FEATURES	DB KILLER Z038.10120

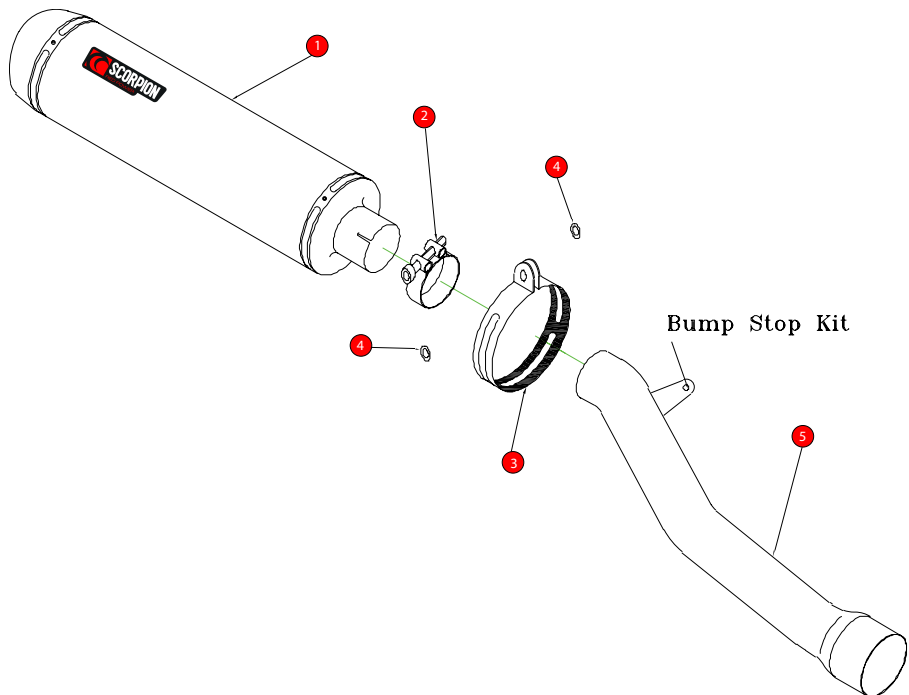

- 1 450mm Silencer ESC 50
- 2 51-55mm Band Clamp (Z016.10002)
- 3 Composite Silencer Strap(R-Z038.10089)(O-Z038.10087)
- 4 2 x M8 x 25mm Washers (Z017.10825)
- 5 Connecting Pipe CP 33
- 6 Bump Stop Kit (Z017.10010)

E-MARK ROUND	SCDB-RS e4 2035
E-MARK OVAL	SCDB-OS e4 2072
ISSUE NO.	9
DATE	01/09/08
AUTHORISED	S.Northrop
CHECKED	

NOTE: ENSURE SCORPION SYSTEM IS CLEAR OF MOVING PARTS AND ALL ORIGINAL FUNCTIONS WORK CORRECTLY.

- A) Remove original exhaust from bike, taking care to keep all original components in a safe place.
- B) Refit Scorpion exhaust as per line diagram above.
- C) When fitted take bike for a short ride to ensure all functions are correct.
- D) When bike & exhaust are cool enough check all nuts and bolts are still secure.