

Box: PLOCK 1

BIKE	BMW S1000 RR / BMW S1000 R	PART NO.	BM1000
YEAR	2009 - 14 / 2014-Current	FIT KITS	Z039.10588
NOTES	Where not supplied, use original fittings.	FEATURES	No dB Killer required. This product is EC approved without a dB killer being fitted.

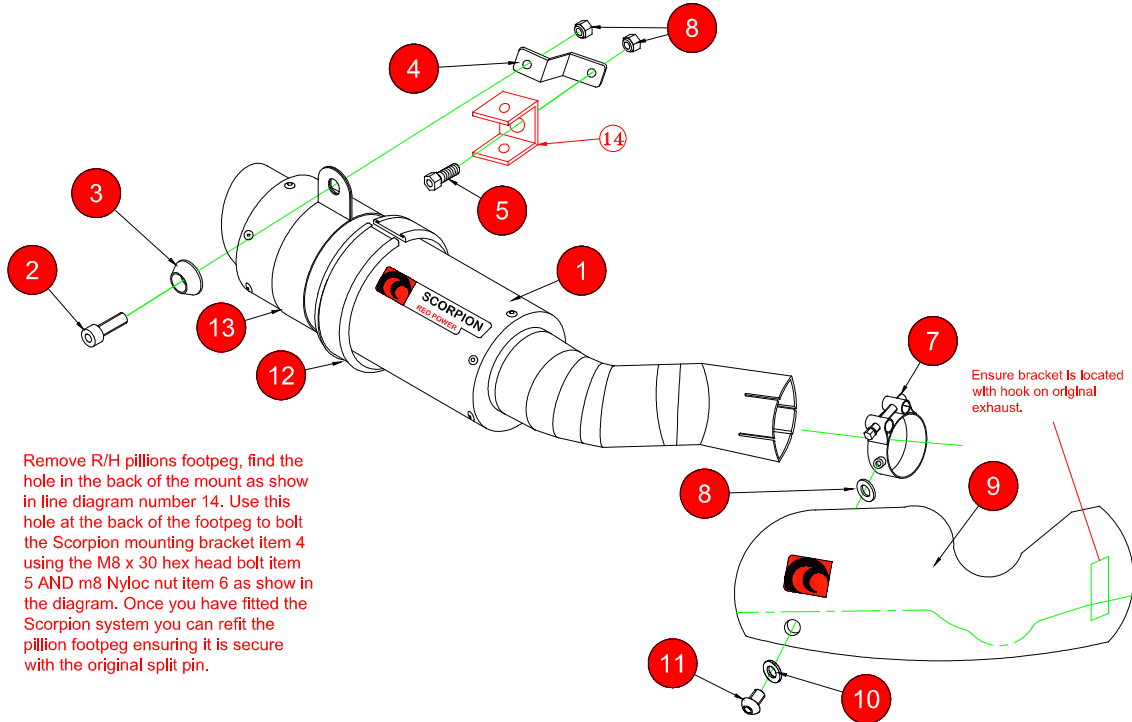

Remove R/H pillions footpeg, find the hole in the back of the mount as show in line diagram number 14. Use this hole at the back of the footpeg to bolt the Scorpion mounting bracket item 4 using the M8 x 30 hex head bolt item 5 AND m8 Nyloc nut item 6 as show in the diagram. Once you have fitted the Scorpion system you can refit the pillion footpeg ensuring it is secure with the original split pin.

- | | |
|---|---|
| 1 225mm RP-1 GP Silencer SC160 with intergrated CP587 | 8 M6 Fibre Washer (Z017.12748) |
| 2 M8x25 Cap Head Bolt (Z017.10073) | 9 Carbon Panel (Z028.20123) |
| 3 Alloy Bolt Finisher (Z026.20068) | 10 M6x12 Washer (Z017.10617) |
| 4 Mounting Bracket (Z015.30938) | 11 M6x8mm Botton Head (Z017.10001) |
| 5 M8x30 Hex Head Bolt (Z017.10049) | 12 Square Edge Rubber (Z029.10024) |
| 6 2 off M8 Nyloc Nuts (Z017.10062) | 13 Titanium Silencer Strap (Z028.10013) |
| 7 Band Clamp WITH boss (Z028.20122) | 14 R/H Original Pillon Footrest |

E-MARK	SC-26 e4 2168
ISSUE NO.	7
DATE	16/02/17
AUTHORISED	M.Ydlibi
CHECKED	

NOTE: ENSURE SCORPION SYSTEM IS CLEAR OF MOVING PARTS AND ALL ORIGINAL FUNCTIONS WORK CORRECTLY.



A) Remove original exhaust from bike, taking care to keep all original components in a safe place.

B) Refit Scorpion exhaust as per line diagram above.

C) When fitted take bike for a short ride to ensure all functions are correct.

D) When bike & exhaust are cool enough check all nuts and bolts are still secure.