

BIKE	HONDA CBR 1000 RR	PART NO.	RHA - 95
YEAR	2008 - 2011	FIT KITS	Z039.20440
NOTES	Bung and copper washer to be replaced by OE lambda probe. (not applicable to non catalyst models)	FEATURES	DB KILLER Z028.20168 (Y)

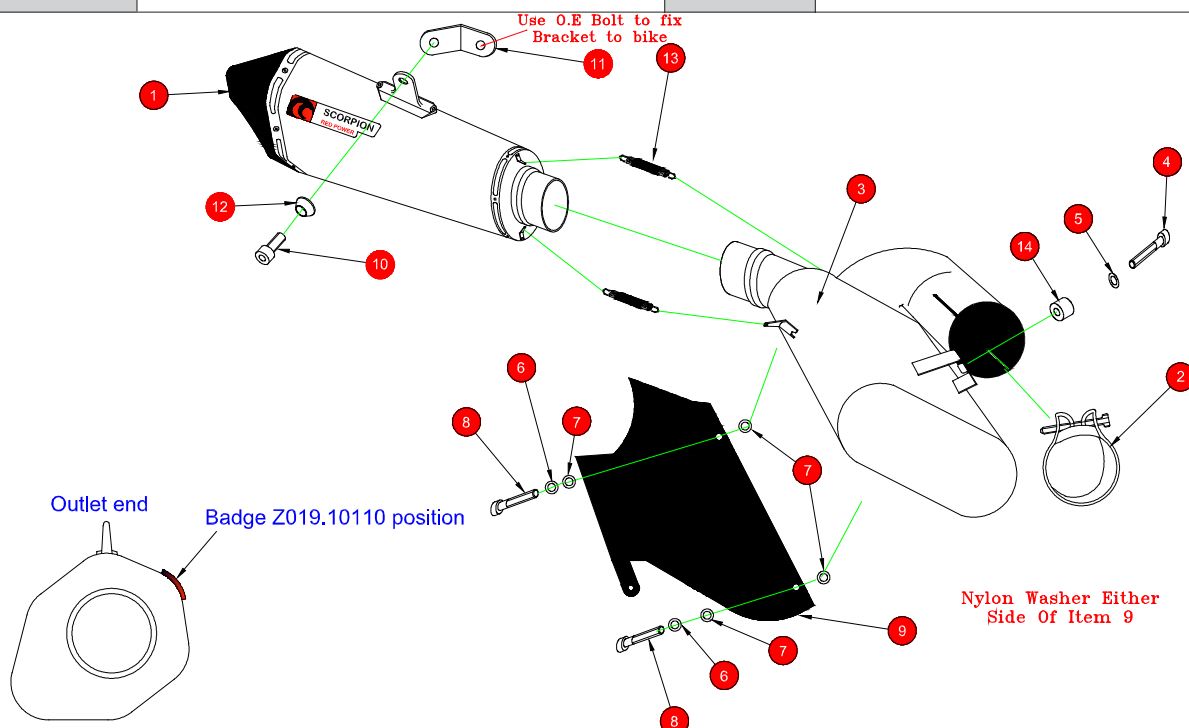

- | | |
|---|---|
| 1 Serket Silencer RSC 223 | 9 Carbon Fibre Fairing (Z028.10214) |
| 2 51-55mm Band Clamps (Z016.10002) | 10 M8x20mm Cap Head Bolt (Z017.10072) |
| 3 Connecting Box CP668 | 11 Mounting Bracket (Z015.30942) |
| 4 M8 x 30mm Cap Head (Z017.10074) | 12 Alloy Bolt Finisher (Z026.20068) |
| 5 M8 x 17mm Washer (Z017.10831) | 13 Rubber Coated Springs (Z028.10030) |
| 6 2 x M6 Star Washers (Z017.10614) | 14 15mm Alloy Spacer (Z026.10005) |
| 7 4 x Nylon Washers (Z017.12748) | 15 Heat Shield Left & Right (Z028.10220) (Z028.10219) |
| 8 2 x M6 x 10mm Button Heads (Z017.12707) | |

E-MARK BOX	HA-95 2295 ⑤ ⑨
E-MARK OVAL	HA-95 2295 ⑨
ISSUE NO.	3
DATE	27/01/17
AUTHORISED	M.Ydlibi
CHECKED	

NOTE: ENSURE SCORPION SYSTEM IS CLEAR OF MOVING PARTS AND ALL ORIGINAL FUNCTIONS WORK CORRECTLY.

Fitting instructions overleaf:



BIKE	HONDA CBR 1000 RR	PART NO.	RHA - 95
YEAR	2008 - 2011	FIT KITS	Z039.20440
NOTES	Bung and copper washer to be replaced by OE lambda probe. (not applicable to non catalyst models)	FEATURES	DB KILLER Z028.20168 (Y)

CONTINUED FROM OVERLEAF:



A) Remove 2 x side panels to allow seat to be removed.

B) With seat removed you can now gain access to unbolt the servo, DO NOT DISCONNECT SERVO.

C) You can now disconnect the servo cable, and then re-fit the servo unit.

D) To allow access unbolt lower fairing on left hand side of bike, this will then allow you to remove the lambda sensor.



E) Undo the clamp holding the O.E exhaust silencer.

F) Remove the bolt holding O.E silencer to footrest.

G) The O.E silencer now can be removed from the bike.

H) Take the supplied heat mat and fit inside of the fairing.



Box: Case 11

BIKE	HONDA CBR 1000 RR	PART NO.	RHA - 95
YEAR	2008 - 2011	FIT KITS	Z039.20440
NOTES	Bung and copper washer to be replaced by OE lambda probe. (not applicable to non catalyst models)	FEATURES	DB KILLER Z028.20168 (Y)

CONTINUED FROM OVERLEAF:



I) Slide the underbelly box onto the original pipework and tighten up the clamp.

J) Tighten up the bolt into mounting bracket.

K) For cat model bikes, re fit lambda sensor in mounting boss and tighten.
For none cat models, use the bung provided to put into the lambda boss and tighten up.

With the underbelly box, lambda sensor on and all tightened up you can now fasten the fairing back into place.



L) Fit the Scorpion silencer onto the outlet of the underbelly box.

M) Bolt through bracket onto footrest. When silencers are aligned tighten both the clamp and bracket.

N) Fit scorpion supplied infill panel and tighten up 3 bolts. Ensuring that 2 holes under silencer are aligned first. Fibre washers MUST be used between panel and underbelly silencer.



When all the above steps have been completed double check all nuts and bolts are tight and that all original bike functions are not impaired. When satisfied fitment is correct take your bike for a short run to ensure system is sealed correctly and there are no gas leaks. After a short run, allow your bike to cool and check all nuts and bolts are tight.

Cleaning instructions overleaf:

Box: Case 11

BIKE	HONDA CBR 1000 RR	PART NO.	RHA - 95
YEAR	2008 - 2011	FIT KITS	Z039.20440
NOTES		FEATURES	DB KILLER Z028.20168 (Y)

Thank you for purchasing your Scorpion Silencer.

Care of your exhaust: Please refrain from cleaning silencer with heavy solvents or abrasives!

Vielen Dank Für den kauf eines Scorpion Schalldampfers! Pflegehinweis: Bitte verwenden Sie niemals Scheuermittel oder aggressive Reiniger zur Pflege Ihres Auspuffes!

Merci d'avoir choisi un echappement Scorpion.

Entretien de votre silencieux: Ne pas utiliser de solvants ou de produits abrasifs!

"Muchas gracias por adquirir un Silencioso Scorpion. Le recomendamos no limpiar el silencioso con productos abrasivos o aquellos que contengan disolventes."