

Box: PLOCK 2

BIKE	KAWASAKI Z 1000	PART NO.	EKA-69
YEAR	2003 - 2006	FIT KITS	OVAL Z039.11071 // ROUND Z039.10071
NOTES	Where not supplied use original fittings	FEATURES	DB KILLER Z038.10120

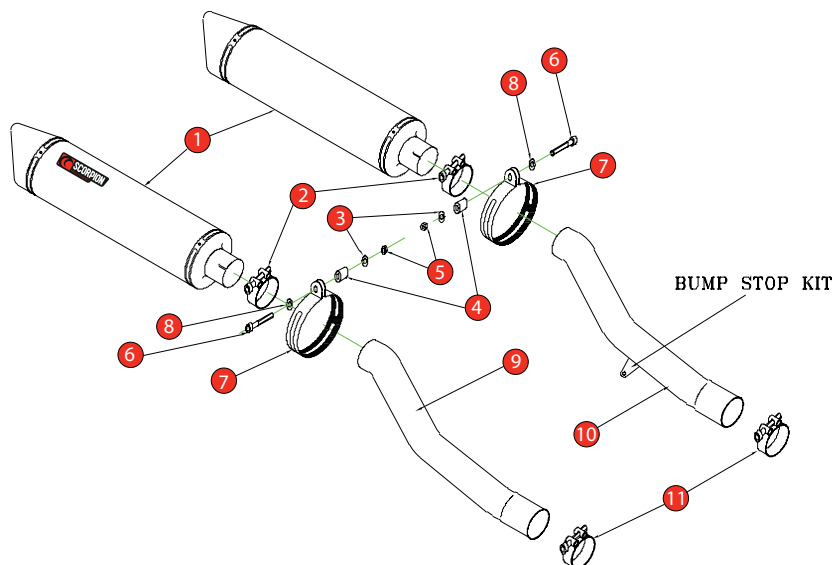

- |  |   |
|--|---|
| 1 2 x 450mm Silencers ESC 50                             | 8 2 x M10 x 25mm Washers (Z017.11014)   |
| 2 2 x 51-55mm Band Clamps (Z016.10002)                   | 9 Connecting Pipe CP 134                |
| 3 2 x M10 x 17mm Washers (Z017.10108)                    | 10 Connecting Pipe CP 135               |
| 4 2 x 30mm (M10) Aluminium Spacers (Z026.10101)          | 11 2 x 47-51mm Band Clamps (Z016.10003) |
| 5 2 x M10 Nyloc Nuts (Z017.10103)                        | 12 Bump Stop Kit (Z017.10010)           |
| 6 2 x M10 x 90mm Cap Head Bolts (Z017.12755)             |   |
| 7 2 x Comp/ Silencer Straps (R-Z038.10090)(O-Z038.10088) |   |

E-MARK ROUND	SCDB-RS <a href="#">e4</a> 2035
E-MARK OVAL	SCDB-OS <a href="#">e4</a> 2072
ISSUE NO.	8
DATE	01/09/08
AUTHORISED	S.Northrop
CHECKED	

**NOTE:** ENSURE SCORPION SYSTEM IS CLEAR OF MOVING PARTS AND ALL ORIGINAL FUNCTIONS WORK CORRECTLY.

A) Remove original exhaust from bike, taking care to keep all original components in a safe place.

B) Refit Scorpion exhaust as per line diagram above.

C) When fitted take bike for a short ride to ensure all functions are correct.

D) When bike & exhaust are cool enough check all nuts and bolts are still secure.