

Box: PLOCK 1

BIKE	SUZUKI GSX-R 600 / GSX-R 750	PART NO.	SI-1000
YEAR	2006-07	FIT KITS	Z039.10369
NOTES	Use standard fittings where not supplied Remove standard gasket if fitted.	DB-Killer	SCEXDBK28 - (Type EE)

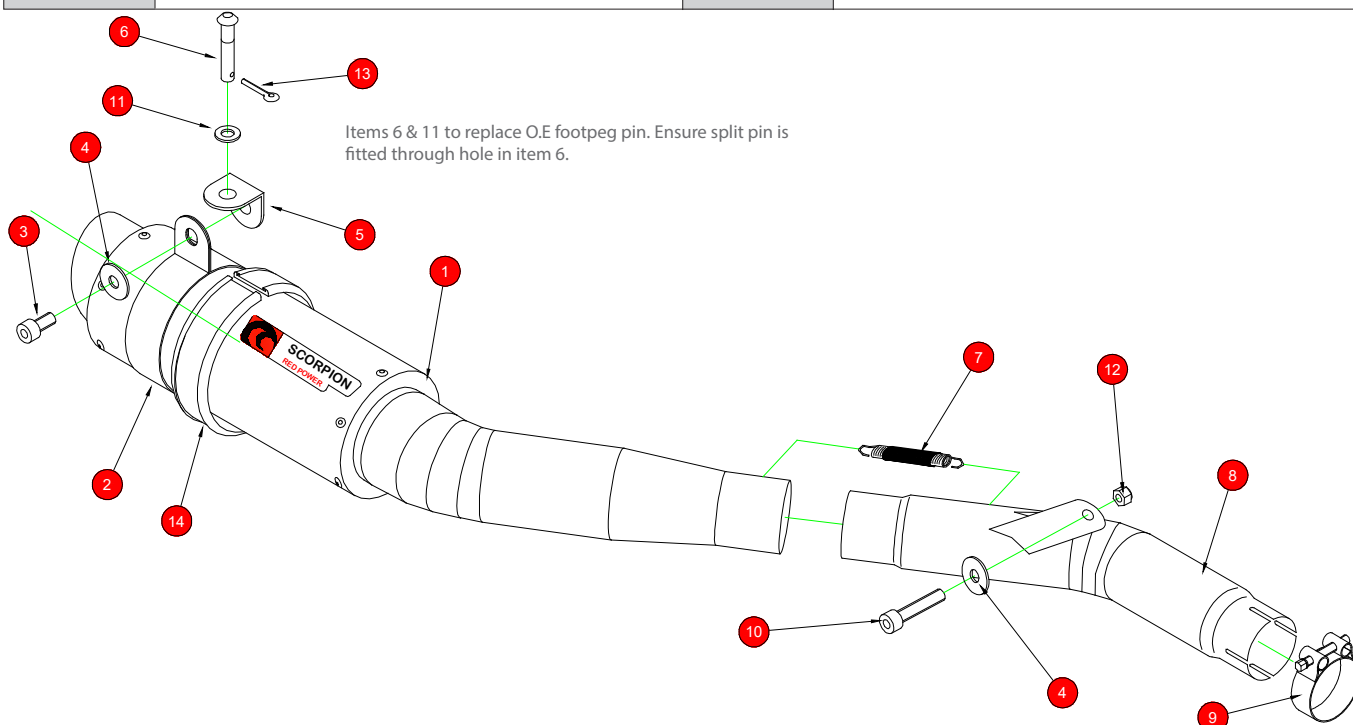

- | | |
|---|---|
| 1 225mm RP1-GP Silencer (SC160) with Intergrated (CP567) | 8 Connecting Pipe CP566 |
| 2 Titanium Silencer Strap (Z028.10013) | 9 51-55mm Band Clamp (Z016.10002) |
| 3 M8x16mm Button Head Bolt (Z017.10812) | 10 M8x40mm Cap Head Bolt (Z017.10078) |
| 4 2 off M8x17mm Washers (Z017.10068) | 11 M8x17mm Washer (Z017.10831) |
| 5 Mounting Bracket (Z015.10090) | 12 M8 Nyloc Nut (Z017.10062) |
| 6 M8x45mm Button Head Bolt With Split Pin Hole (Z017.10007) | 13 Ø 3x20mm Split Pin (Z017.10008) |
| 7 Rubber Sleeved Spring (Z028.10030) | 14 Square Edge Rubber (275mm long) (Z029.10024) |

CLASSIFICATION	Closed Circuit Product
HOMOLOGATED	No
ISSUE NO.	04
DATE	19/10/2018
AUTHORISED	J.Harkin

NOTE: ENSURE SCORPION SYSTEM IS CLEAR OF MOVING PARTS AND ALL ORIGINAL FUNCTIONS WORK CORRECTLY.



A) Remove original exhaust from bike, taking care to keep all original components in a safe place.

B) Refit Scorpion exhaust as per line diagram above.

C) When fitted take bike for a short ride to ensure all functions are correct.

D) When bike & exhaust are cool enough check all nuts and bolts are still secure.

