

|       |   |           |       |
|-------|---|-----------|-------|
| Bike  | KTM Duke 990                              | Part No.  | KT-96 |
| Year  | 2024-Current                              | Fit Kit   | N/A   |
| Notes | Where not supplied use original fittings. | dB Killer | N/A   |

Estimated Fitting Time: 60 Minutes

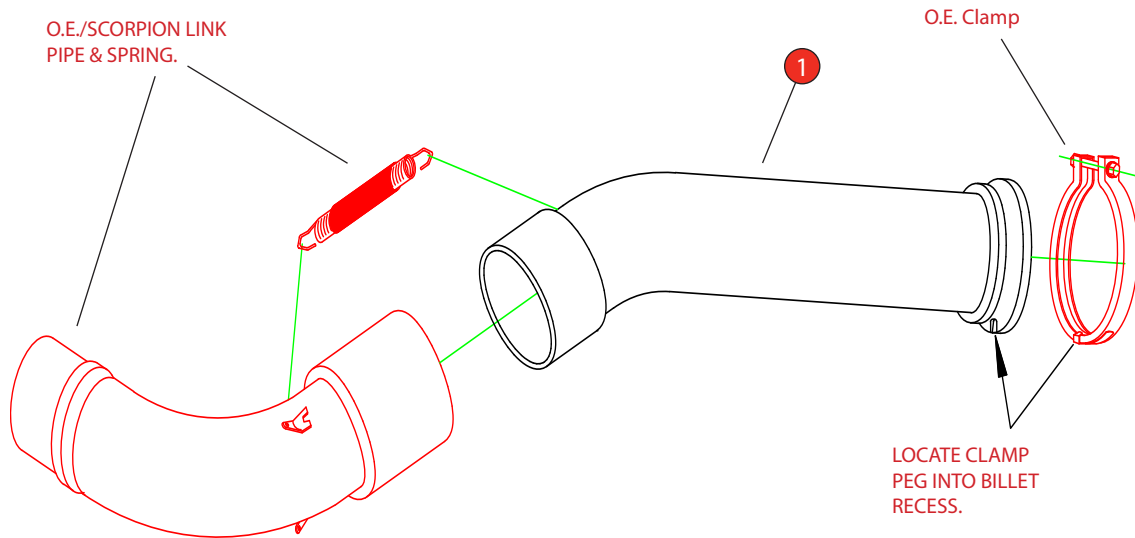

| NO. | PART NO. | DESCRIPTION            | QTY |
|-----|----------|------------------------|-----|
| 1   | CP1217   | Centre Silencer Delete | 1   |

**NOTE:** ENSURE SCORPION SYSTEM IS CLEAR OF MOVING PARTS AND ALL ORIGINAL FUNCTIONS WORK CORRECTLY.

|                |                        |
|----------------|------------------------|
| CLASSIFICATION | Closed Circuit Product |
| HOMOLOGATED    | NO                     |
| DATE           | 23/04/2025             |
| ISSUE          | 00                     |
| AUTHORISED     | G O'Shea               |



<https://youtu.be/-myu443Zzs>



STAY CONNECTED TO RED POWER.

|       |   |           |       |
|-------|---|-----------|-------|
| Bike  | KTM Duke 990                              | Part No.  | KT-96 |
| Year  | 2024-Current                              | Fit Kit   | N/A   |
| Notes | Where not supplied use original fittings. | dB Killer | N/A   |

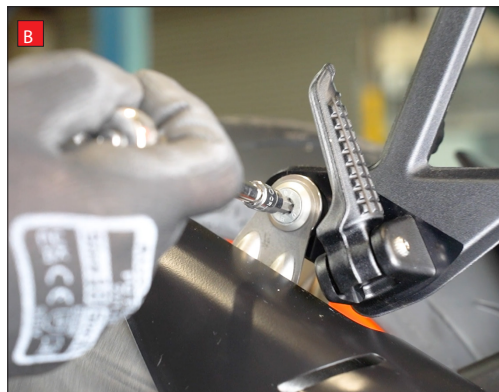

**PLEASE NOTE:**

You will need to remove the side stand during installation of the Scorpion Centre Silencer Delete so you will require a paddock stand or similar to carry out the job. Once installed the stand can be refitted.

A) Remove the spring between the centre silencer and rear silencer.

B) Remove the rear silencer mounting bolt.

C) Carefully remove the rear silencer.

D) Remove the heat shield from the catalyst.

E) Remove the plastic cover from the back of the sump.

F) On the left hand side of the bike, remove the side stand sensor.

G) Next, remove the 3 bolts above it that hold the side stand frame to the bike.

H) On the right hand side of the bike remove the 2 bolts for the side stand frame, then remove the frame from the bike.





|       |   |           |       |
|-------|---|-----------|-------|
| Bike  | KTM Duke 990                              | Part No.  | KT-96 |
| Year  | 2024-Current                              | Fit Kit   | N/A   |
| Notes | Where not supplied use original fittings. | dB Killer | N/A   |

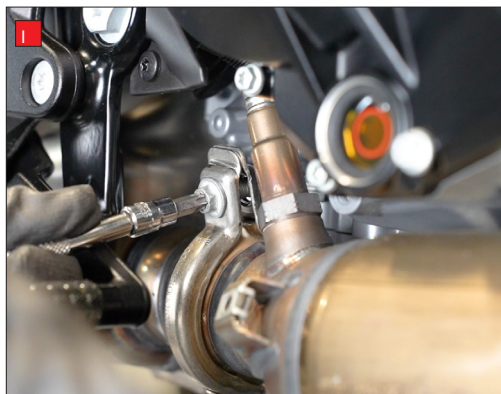

I) Remove the clamp between the cat and the centre silencer.

J) On the left hand side of the bike, remove the centre silencer mounting bolt.

K) On the right hand side of the bike, support the weight of the silencer, then remove the mounting bolt.

L) Carefully remove the silencer from the bike.

M) Remove the 2 speed nuts that the silencer mounted to so they don't come off when riding, or if you want to save some weight you can remove the bracket all together.

N) Put the Scorpion Silencer Delete Pipe in position and loosely secure in place with the original clamp, you will fully tighten in a later step. Ensure that the tab on the clamp is aligned with the notch on the pipe.

Refitting the original silencer.  
 If fitting with the Scorpion Slip-on, refer to those instructions where necessary.

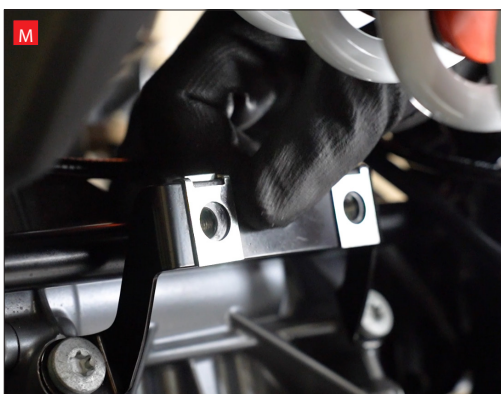
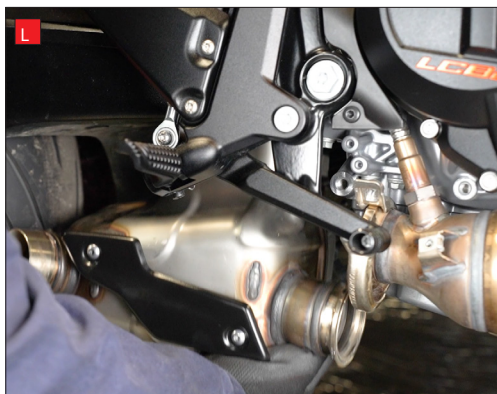

O) Slide the silencer onto the Scorpion delete pipe and line the mounting bracket up with the mount on the frame.

P) Secure the silencer in place with the original mounting bolt. Leave loose for now, you will fully tighten in a later step.





|       |   |           |       |
|-------|---|-----------|-------|
| Bike  | KTM Duke 990                              | Part No.  | KT-96 |
| Year  | 2024-Current                              | Fit Kit   | N/A   |
| Notes | Where not supplied use original fittings. | dB Killer | N/A   |



Q) Fit the original spring between the silencer and Scorpion delete pipe.

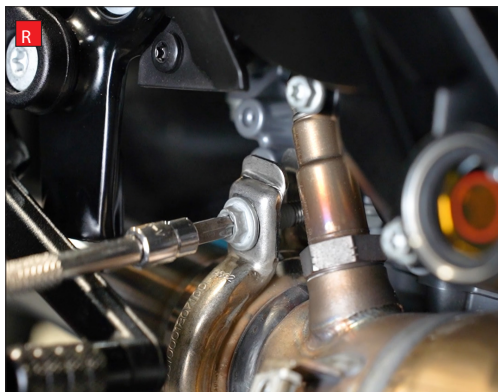

R) Adjust the system if necessary then fully tighten the clamp.

S) Fully tighten the silencer mounting bolt.

T) Refit the side stand frame.

U) Refit the side stand sensor.

V) Refit the plastic cover.

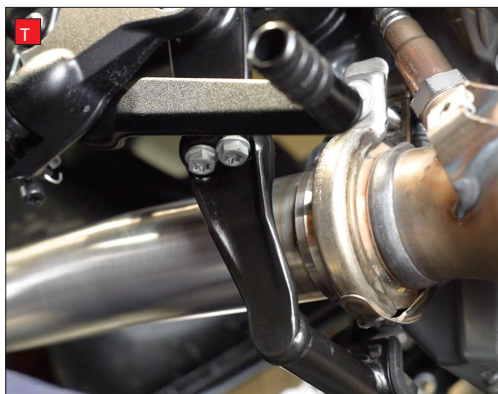

W) Refit the heat shield to the cat.

When fitted take bike for a short ride to ensure all functions are correct. When bike & exhaust are cool enough check all nuts and bolts are still secure.



|       |   |           |       |
|-------|---|-----------|-------|
| Bike  | KTM Duke 990                              | Part No.  | KT-96 |
| Year  | 2024-Current                              | Fit Kit   | N/A   |
| Notes | Where not supplied use original fittings. | dB Killer | N/A   |

Estimated Fitting Time: 60 Minutes



Thank you for purchasing your Scorpion Silencer.

Care of your exhaust: Please refrain from cleaning silencer with heavy solvents or abrasives!

Vielen Dank Für den kauf eines Scorpion Schalldampfers! Pflegehinweis: Bitte verwenden Sie niemals Scheuermittel oder aggressive Reiniger zur Pflege Ihres Auspuffes!

Merci d'avoir choisi un echappement Scorpion.

Entretien de votre silencieux: Ne pas utiliser de solvants ou de produits abrasifs!

Muchas gracias por adquirir un Silencioso Scorpion. Le recomendamos no limpiar el silencioso con productos abrasivos o aquellos que contengan disolventes.



STAY CONNECTED TO RED POWER.